



# Cabinets ORDER FORM

Submit to: [sales@ddninteriorsupplyinc.com](mailto:sales@ddninteriorsupplyinc.com)

Once Estimate is received, please 'reply all' with approval or changes requested.

COMPANY NAME: \_\_\_\_\_

JOB NAME: \_\_\_\_\_

CUSTOMER NAME: \_\_\_\_\_

PHONE NUMBER: \_\_\_\_\_

EMAIL ADDRESS: \_\_\_\_\_

JOB ADDRESS (if applicable): \_\_\_\_\_

PO NUMBER: \_\_\_\_\_  WILL-CALL PICKUP  DELIVERY  INSTALL

DATE: \_\_\_\_\_  WHITE SHAKER  GREY SHAKER  MAPLE SHAKER

## Base & Vanity Cabinets (Lowers)

QTY	Bases
	B09
	B12
	B15
	B18
	B21
	B24
	B27
	B30
	B33
	B36
	B39
	B42
	B48

QTY	Drawer Bases
	DB12
	DB15
	DB18 3 Drawer
	DB18 4 Drawer
	DB21
	DB24
	DB27

QTY	Sink Bases
	SB24
	SB27
	SB30
	SB33
	SB36
	SB39
	SB42

QTY	Blind Corners
	BBC36-12 (Pulls to 39")
	BBC36-15 (Pulls to 42")
	BBC42-15 (Pulls to 45")
	BBC48-21 (Pulls to 48")

QTY	Lazy Susans
	DCB33-09
	DCB36-12

QTY	ADA Drawer Bases
	DB12 ADA
	DB15 ADA
	DB18 3 Drawer ADA
	DB18 4 Drawer ADA
	DB24 ADA

QTY	ADA Sink Bases
	SB30 ADA
	SB33 ADA
	SB36 ADA

QTY	Easy Reach Corners
	ER33-09
	ER36-12

QTY	ADA Bases
	B09 ADA
	B12 ADA
	B15 ADA
	B18 ADA
	B21 ADA
	B24 ADA
	B27 ADA
	B30 ADA
	B33 ADA

QTY	Vanity Drawer Bases
	VDB09
	VDB12
	VDB15
	VDB18
	VDB21
	VDB24

QTY	Vanity Sink Bases
	VSB21
	VSB24
	VSB27
	VSB30
	VSB33
	VSB36
	VSB39
	VSB42

QTY	Vanity Sets
	VSB42SET (9" Drawer)
	VSB48SET (12" Drawer)

QTY	Tall Vanity Sets
	TVSB42SET (9" Drawer)
	TVSB48SET (12" Drawer)

QTY	Vanity Bases
	VB09
	VB12
	VB15
	VB18
	VB30

QTY	Tall Vanity Drawer Base
	TVDB09
	TVDB12
	TVDB15
	TVDB18
	TVDB24

QTY	Tall Vanity Sink Bases
	TVSB24
	TVSB27
	TVSB30
	TVSB33
	TVSB36

### NOTES

Kitchen Base Height: **34 1/2"**  
 Kitchen Base Depth: **24"**  
 ADA Kitchen Base Height: **32 1/2"**  
 ADA Kitchen Base Depth: **23"**  
 Vanity Base Height: **31"**  
 Vanity Base Depth: **21"**  
 Tall Vanity Base Height: **34 1/2"**  
 Tall Vanity Base Depth: **21"**

QTY	Tall Vanity Bases
	TVB09
	TVB15
	TVB24

### Wall Cabinets (Uppers)

QTY	Wall 1 Door
	W1518
	W1818
	W1224
	W1824
	W0930
	W1230
	W1530
	W1830
	W2130
	W0936
	W1236
	W1536
	W1836
	W2136
	W0940
	W1240
	W1540
	W1840
	W2140

QTY	Medicine Cabinet
	MC1624

QTY	Wall Pantry 12" Deep
	WP241284

**NOTES**

Wall Cabinet Depth: 12"  
 Wall Pantry Standard Depth: 24"  
 Wall Pantry Reduced Depth: 12"  
 Wall Pantry can be custom depth

QTY	Wall 2 Doors
	W2412
	W3012
	W3312
	W3612
	W3015
	W3315
	W3615
	W3915
	W2418
	W2718
	W3018
	W3318
	W3618
	W3918

QTY	Wall Pantry 24" Deep
	WP1284
	WP1884
	WP2484
	WP2484 Water Heater
	WP3684
	WP1890
	WP2490
	WP3690
	WP1294
	WP1894
	WP2494
	WP3694

QTY	Wall 2 Doors
	W2421
	W2721
	W3021
	W3321
	W3621
	W4221
	W2424
	W3024
	W3324
	W3624
	W3924
	W3027
	W3327
	W3627
	W2430
	W2730
	W3030
	W3330
	W3630
	W3930
	W4230
	W4830

QTY	Wall Corner Shelves
	WES1230
	WES1236

QTY	Wall 2 Doors
	W2436
	W2736
	W3036
	W3336
	W3636
	W3936
	W4236
	W2440
	W2740
	W3040
	W3340
	W3640
	W3940
	W4240

QTY	Wall Blind Corner
	WBC24/2730 (Pulls to 27")
	WBC30/3330 (Pulls to 33")
	WBC36/3930 (Pulls to 39")
	WBC24/2736 (Pulls to 27")
	WBC30/3336 (Pulls to 33")
	WBC36/3936 (Pulls to 39")
	WBC24/2740 (Pulls to 27")
	WBC30/3340 (Pulls to 33")
	WBC36/3940 (Pulls to 39")

QTY	Wall Diagonal Corner
	WDC2430
	WDC2436
	WDC2440

### Trim & Other

QTY	Trim & Accessories
	BM8
	BP4896
	CM8
	CORBELS
	DWR
	FP4896
	OCM8
	QR8
	REP96
	SM8
	TKC

QTY	Fillers
	TF396
	TF696
	WF196
	WF330
	WF336
	WF340
	WF630
	WF636
	WF640

**NOTES**

**BM8** = Base Molding 8ft Length (or 96")  
**BP4896** = Back Panel 1/4" Thick x 48" x 96"  
**CM8** = Crown Molding 8ft Length (or 96")  
**CORBEL** = Support for Countertop Overhangs, Color-Matched to Cabinets  
**DWR** = Dishwasher End Panel  
**FP4896** = Finish Panel 3/4" Thick x 48" x 96"  
**OCM8** = Outside Corner Molding 1/2" x 96"  
**QR8** = Quarter Round Molding 8ft Length (or 96")  
**REP96** = Refrigerator End Panel 1/2" Thick x 24" x 96" or 48" x 96"  
**SM8** = Scribe Molding 8ft Length (or 96")  
**TKC** = Toe Kick

**REQUESTS & COMMENTS:**

Completed by (Name): \_\_\_\_\_

Order subject to current stock and availability. Not all cabinets or materials may be in stock at time of order. Substitutions may need to be utilized. Contact DDN for more information.

(A) ADA = Depth -1" and Height -2"  
 (T) Tall = Vanity Height +3.5"

Width x Depth x Height

● White ● Grey ● Maple  
 (A) ADA Available (T) Tall Vanity Available

## Kitchen

**B09** ● ● ● (A)  
9" x 24" x 34 1/2"

**B12** ● ● ● (A)  
12" x 24" x 34 1/2"

**B15** ● ● ● (A)  
15" x 24" x 34 1/2"

**B18** ● ● ● (A)  
18" x 24" x 34 1/2"

**B21** ● ● ● (A)  
21" x 24" x 34 1/2"

**B24** ● ● ● (A)  
24" x 24" x 34 1/2"

**B27** ● ● ● (A)  
27" x 24" x 34 1/2"

**B30** ● ● ● (A)  
30" x 24" x 34 1/2"

**B33** ● ● ● (A)  
33" x 24" x 34 1/2"

**B36** ● ● ● (A)  
36" x 24" x 34 1/2"

**B39** ● ● ● (A)  
39" x 24" x 34 1/2"

**B42** ● ● ● (A)  
42" x 24" x 34 1/2"

**B48** ● ● ● (A)  
48" x 24" x 34 1/2"

**BBC36-12** ● ● ● (A)  
36" x 24" x 34 1/2" (12" Door)

**BBC36-15** ● ● ● (A)  
36" x 24" x 34 1/2" (15" Door)

**BBC42-15** ● ● ● (A)  
42" x 24" x 34 1/2" (15" Door)

**BBC48-18** ● ● ● (A)  
48" x 24" x 34 1/2" (18" Door)

**Note:** BBC36-12 has no Drawer

**SB24** ● ● ● (A)  
24" x 24" x 34 1/2"

**SB27** ● ● ● (A)  
27" x 24" x 34 1/2"

**SB30** ● ● ● (A)  
30" x 24" x 34 1/2"

**SB33** ● ● ● (A)  
33" x 24" x 34 1/2"

**SB36** ● ● ● (A)  
36" x 24" x 34 1/2"

**SB39** ● ● ● (A)  
39" x 24" x 34 1/2"

**SB42** ● ● ● (A)  
42" x 24" x 34 1/2"

**DB12** ● ● ● (A)  
12" x 24" x 34 1/2"

**DB15** ● ● ● (A)  
15" x 24" x 34 1/2"

**DB18** ● ● ● (A)  
18" x 24" x 34 1/2"

**DB21** ● ● ● (A)  
21" x 24" x 34 1/2"

**DB24** ● ● ● (A)  
24" x 24" x 34 1/2"

**DB27** ● ● ● (A)  
27" x 24" x 34 1/2"

**DB18 4D** ● ● ● (A)  
18" x 24" x 34 1/2"

**DCB33-09** ● ● ● (A)  
33" x 24" x 34 1/2" (9" Door)

**DCB36-12** ● ● ● (A)  
36" x 24" x 34 1/2" (12" Door)

**ER33-09** ● ● ● (A)  
33" x 24" x 34 1/2" (9" Door)

**ER36-12** ● ● ● (A)  
36" x 24" x 34 1/2" (12" Door)

**SB30 ADA** ● ● ● (A)  
30" x 23" x 32 1/2"

**SB33 ADA** ● ● ● (A)  
33" x 23" x 32 1/2"

**SB36 ADA** ● ● ● (A)  
36" x 23" x 32 1/2"

**INDEX**

**B** = Base

**BBC** = Blind Base Corner

**DB** = Drawer Base

**DCB** = Lazy Susan Corner

**ER** = Easy Reach Corner

**SB** = Sink Base

## Bathroom

**VB09** ● ● ● (T)  
9" x 21" x 31"

**VB12** ● ● ● (T)  
12" x 21" x 31"

**VB15** ● ● ● (T)  
15" x 21" x 31"

**VB18** ● ● ● (T)  
18" x 21" x 31"

(Tall Only) **VB24** ● ● ● (T)  
24" x 21" x 34 1/2"

**VB30** ● ● ● (T)  
30" x 21" x 31"

**VDB09** ● ● ● (T)  
9" x 21" x 31"

**VDB12** ● ● ● (T)  
12" x 21" x 31"

**VDB15** ● ● ● (T)  
15" x 21" x 31"

**VDB18** ● ● ● (T)  
18" x 21" x 31"

**VDB21** ● ● ● (T)  
21" x 21" x 31"

**VDB24** ● ● ● (T)  
24" x 21" x 31"

**VSB21** ● ● ● (T)  
21" x 21" x 31"

**VSB24** ● ● ● (T)  
24" x 21" x 31"

**VSB27** ● ● ● (T)  
27" x 21" x 31"

**VSB30** ● ● ● (T)  
30" x 21" x 31"

**VSB33** ● ● ● (T)  
33" x 21" x 31"

**VSB36** ● ● ● (T)  
36" x 21" x 31"

**VSB39** ● ● ● (T)  
39" x 21" x 31"

**VSB42** ● ● ● (T)  
42" x 21" x 31"

**VSB42SET** ● ● ● (T)  
42" x 21" x 31"

**VSB48SET** ● ● ● (T)  
48" x 21" x 31"

**INDEX**

**VB** = Vanity Base

**VDB** = Vanity Drawer Base

**VSB** = Vanity Sink Base

**VSBSET** = Vanity Set

Width x Depth x Height

● White ● Grey ● Maple

## Uppers

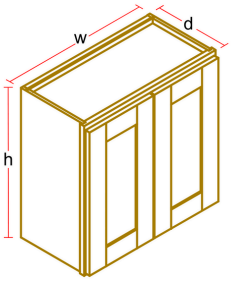

**W2430** ● ● ●

24" x 12" x 30"

**W2730** ● ● ●

27" x 12" x 30"

**W3030** ● ● ●

30" x 12" x 30"

**W3330** ● ● ●

33" x 12" x 30"

**W3630** ● ● ●

36" x 12" x 30"

**W3930** ● ● ●

39" x 12" x 30"

**W4230** ● ● ●

42" x 12" x 30"

**W4830** ● ● ●

48" x 12" x 30"

**W2436** ● ● ●

24" x 12" x 36"

**W2736** ● ● ●

27" x 12" x 36"

**W3036** ● ● ●

30" x 12" x 36"

**W3336** ● ● ●

33" x 12" x 36"

**W3636** ● ● ●

36" x 12" x 36"

**W3936** ● ● ●

39" x 12" x 36"

**W4236** ● ● ●

42" x 12" x 36"

**W4836** ● ● ●

48" x 12" x 36"

**W2440** ● ● ●

24" x 12" x 40"

**W2740** ● ● ●

27" x 12" x 40"

**W3040** ● ● ●

30" x 12" x 40"

**W3340** ● ● ●

33" x 12" x 40"

**W3640** ● ● ●

36" x 12" x 40"

**W3940** ● ● ●

39" x 12" x 40"

**W4240** ● ● ●

42" x 12" x 40"

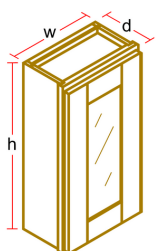

**MC1624** ● ● ●

16" x 6" x 24"

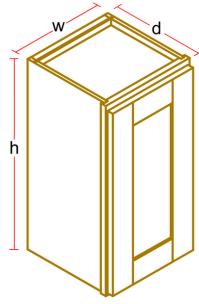

**W1518** ● ● ●

15" x 12" x 18"

**W1818** ● ● ●

18" x 12" x 18"

**W1224** ● ● ●

12" x 12" x 24"

**W1824** ● ● ●

18" x 12" x 24"

**W0930** ● ● ●

9" x 12" x 30"

**W1230** ● ● ●

12" x 12" x 30"

**W1530** ● ● ●

15" x 12" x 30"

**W1830** ● ● ●

18" x 12" x 30"

**W2130** ● ● ●

21" x 12" x 30"

**W0936** ● ● ●

9" x 12" x 36"

**W1236** ● ● ●

12" x 12" x 36"

**W1536** ● ● ●

15" x 12" x 36"

**W1836** ● ● ●

18" x 12" x 36"

**W2136** ● ● ●

21" x 12" x 36"

**W0940** ● ● ●

9" x 12" x 40"

**W1240** ● ● ●

12" x 12" x 40"

**W1540** ● ● ●

15" x 12" x 40"

**W1840** ● ● ●

18" x 12" x 40"

**W2140** ● ● ●

21" x 12" x 40"

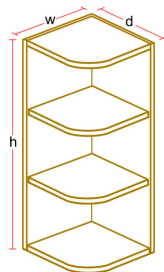

**WES1230** ● ● ●

12" x 12" x 30"

**WES1236** ● ● ●

12" x 12" x 36"

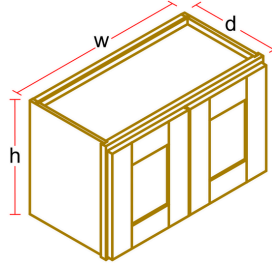

**W2412** ● ● ●

24" x 12" x 12"

**W3012** ● ● ●

30" x 12" x 12"

**W3312** ● ● ●

33" x 12" x 12"

**W3612** ● ● ●

36" x 12" x 12"

**W3015** ● ● ●

30" x 12" x 15"

**W3315** ● ● ●

33" x 12" x 15"

**W3615** ● ● ●

36" x 12" x 15"

**W3915** ● ● ●

39" x 12" x 15"

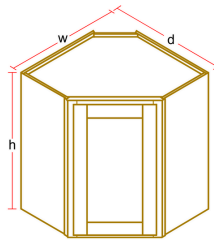

**WDC2430** ● ● ●

24" x 24" x 30"

**WDC2436** ● ● ●

24" x 24" x 36"

**WDC2440** ● ● ●

24" x 24" x 40"

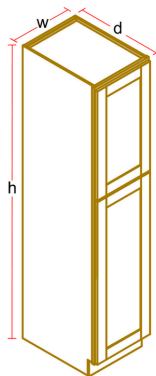

**WP1284** ● ● ●

12" x 24" x 84"

**WP1884** ● ● ●

18" x 24" x 84"

**WP1890** ● ● ●

18" x 24" x 90"

**WP1294** ● ● ●

12" x 24" x 94"

**WP1894** ● ● ●

18" x 24" x 94"

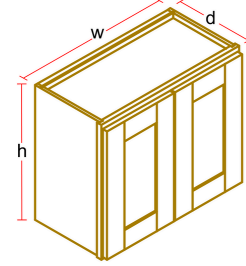

**W2418** ● ● ●

24" x 12" x 18"

**W2718** ● ● ●

27" x 12" x 18"

**W3018** ● ● ●

30" x 12" x 18"

**W3318** ● ● ●

33" x 12" x 18"

**W3618** ● ● ●

36" x 12" x 18"

**W3918** ● ● ●

39" x 12" x 18"

**W4218** ● ● ●

42" x 12" x 18"

**W2421** ● ● ●

24" x 12" x 21"

**W2721** ● ● ●

27" x 12" x 21"

**W3021** ● ● ●

30" x 12" x 21"

**W3321** ● ● ●

33" x 12" x 21"

**W3621** ● ● ●

36" x 12" x 21"

**W4221** ● ● ●

42" x 12" x 21"

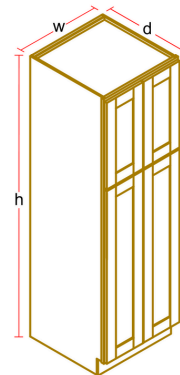

**WP2484** ● ● ●

24" x 24" x 84"

**WP241284** ● ● ●

24" x 12" x 84" (12" Deep)

**WP3684** ● ● ●

36" x 24" x 84"

**WP2490** ● ● ●

24" x 24" x 90"

**WP3690** ● ● ●

36" x 24" x 90"

**WP2494** ● ● ●

24" x 24" x 94"

**WP3694** ● ● ●

36" x 24" x 94"

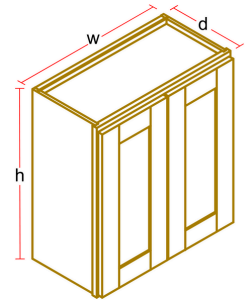

**W2424** ● ● ●

24" x 12" x 24"

**W3024** ● ● ●

30" x 12" x 24"

**W3324** ● ● ●

33" x 12" x 24"

**W3624** ● ● ●

36" x 12" x 24"

**W3924** ● ● ●

39" x 12" x 24"

**W4224** ● ● ●

42" x 12" x 24"

**W3027** ● ● ●

30" x 12" x 27"

**W3327** ● ● ●

33" x 12" x 27"

**W3627** ● ● ●

36" x 12" x 27"

**W4227** ● ● ●

42" x 12" x 27"

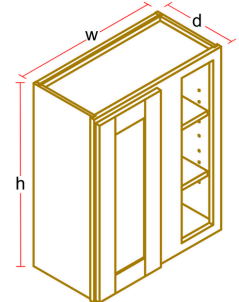

**WBC24/2730** ● ● ●

24-27" x 12" x 30"

**WBC30/3330** ● ● ●

30-33" x 12" x 30"

**WBC36/3930** ● ● ●

36-39" x 12" x 30"

**WBC24/2736** ● ● ●

24-27" x 12" x 36"

**WBC30/3336** ● ● ●

30-33" x 12" x 36"

**WBC36/3936** ● ● ●

36-39" x 12" x 36"

**WBC24/2740** ● ● ●

24-27" x 12" x 40"

**WBC30/3340** ● ● ●

30-33" x 12" x 40"

**WBC36/3940** ● ● ●

36-39" x 12" x 40"

### INDEX

**MC** = Medicine Cabinet

**W** = Wall

**WBC** = Wall Blind Corner

**WDC** = Wall Diagonal Corner

**WES** = Wall End Shelves

**WP** = Wall Pantry

Width x Depth x Height

● White ● Grey ● Maple

### Trim

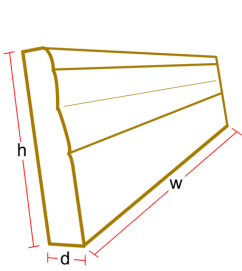

**BM8** ● ● ●  
96" x 3/4" x 4 5/8"

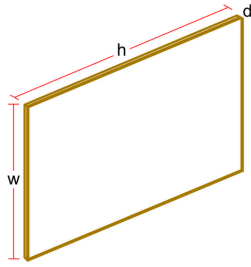

**BP4896** ● ● ●  
48" x 1/4" x 96"

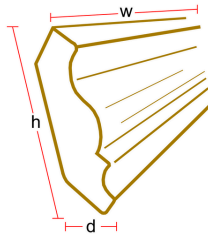

**CM8** ● ● ●  
96" x 3/4" x 2 5/8"

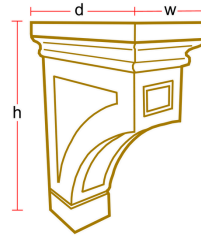

**CORBEL** ● ● ●  
3" x 6" x 9"

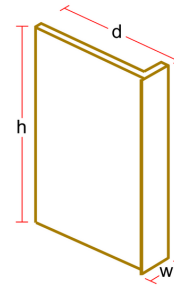

**DWR** ● ● ●  
3" x 24" x 34 1/2"

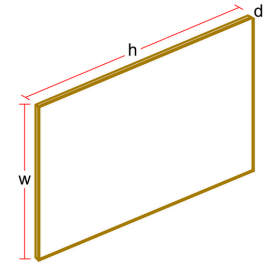

**FP4896** ● ● ●  
48" x 3/4" x 96"

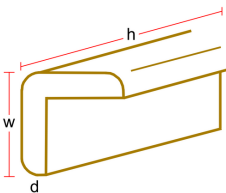

**OCM8** ● ● ●  
1 1/8" x 1/2" x 96"

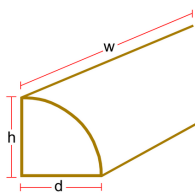

**QR8** ● ● ●  
96" x 3/4" x 3/4"

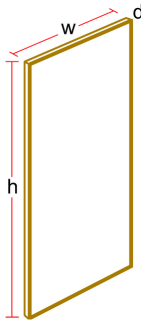

**REP96** ● ● ●  
24 or 48" x 1/2" x 96"

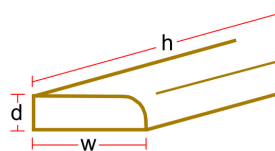

**SM8** ● ● ●  
3/4" x 1/4" x 96"

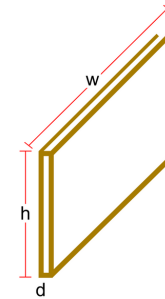

**TKC** ● ● ●  
96" x 1/4" x 4 1/2"

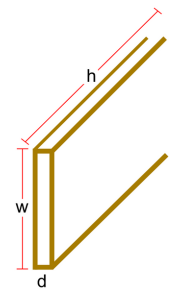

**TF396** ● ● ●  
3" x 3/4" x 96"

**TF696** ● ● ●  
6" x 3/4" x 96"

**WF196** ● ● ●  
1" x 3/4" x 96"

**WF330** ● ● ●  
3" x 3/4" x 30"

**WF336** ● ● ●  
3" x 3/4" x 36"

**WF340** ● ● ●  
3" x 3/4" x 40"

**WF630** ● ● ●  
6" x 3/4" x 30"

**WF636** ● ● ●  
6" x 3/4" x 36"

**WF640** ● ● ●  
6" x 3/4" x 40"

**INDEX**

- BM8** = Base Molding 8ft Length (or 96")
- BP4896** = Back Panel 1/4" Thick x 48" x 96"
- CM8** = Crown Molding 8ft Length (or 96")
- CORBEL** = Support for Countertop Overhangs, Color-Matched to Cabinets
- DWR** = Dishwasher End Panel
- FP4896** = Finish Panel 3/4" Thick x 48" x 96"
- OCM8** = Outside Corner Molding 1/2" x 96"
- QR8** = Quarter Round Molding 8ft Length (or 96")
- REP96** = Refrigerator End Panel 1/2" Thick x 24" x 96" or 48" x 96"
- SM8** = Scribe Molding 8ft Length (or 96")
- TF** = Tall Filler
- TKC** = Toe Kick
- WF** = Wall Filler

### Pulls



**Knob** (Satin Nickel)  
1 1/4" Diameter



**Arch** (Satin Nickel)  
4 1/2" Length



**Cup** (Satin Nickel)  
3" Length



**Bar** (Satin Nickel)  
6" Length  
4" Hole-to-Hole



**Bar** (Black)  
6" Length  
4" Hole-to-Hole



**T Bar** (Black)  
2" Length



## SHAKER SERIES CABINETS COLLECTION

### COLORS



SHAKER STYLE

### MAPLE

Plywood Construction



SHAKER STYLE

### WHITE

Plywood Construction



SHAKER STYLE

### GREY

Plywood Construction



Photos may not perfectly represent cabinet appearance. Please request in-person viewing or physical sample prior to making selection.

**BOX CONSTRUCTION**  
CABINETS COLLECTION



**Full Extension Drawer Slides**



*Fully Extending Drawer*

*Dove Tail*

*Undermount  
Drawer Slides*  
*Soft - Close Hinges*



Photos may not perfectly represent cabinet appearance. Please request in-person viewing or physical sample prior to making selection.

**BOX CONSTRUCTION**  
CABINETS COLLECTION



**True 5/8" Construction**

*Pocket Screws*  
*1" Corner Wood Blocks*



*5/8" Plywood Box on all sides*  
*3/16" Veneer Plywood Back Panel*



*11/16" Adjustable Shelves*

*3/4" Hardwood Drawer Face*

*3/4" Hardwood Cabinet Face*

*3/4" Hardwood Doors*

*4 1/2" Tall Toe Kick*

Photos may not perfectly represent cabinet appearance. Please request in-person viewing or physical sample prior to making selection.